

more
than you
expect



PX Series

DC BRUSH SERVOMOTORS

Serie **PX** 100% Made in Italy, motori in corrente continua da 0,045 a 2,7Nm studiati per la realizzazione di movimentazioni a velocità variabile. Eccellente rapporto qualità/prezzo, linearità di funzionamento ed alta affidabilità. La linea PX è predisposta con alberino posteriore per fissaggio encoder o dinamo tachimetrica. Bassa inerzia, elevata linearità di rotazione lunga durata delle spazzole. Possibilità di abbinare riduttori epicicloidali e freni di stazionamento. Questa gamma si presta in modo ottimale all'abbinamento dei prodotti serie **Dc One**, **Dc One XL** e **Mini DC**.

The **PX** dc brush servomotors series has been developed to meet the requirements of the industrial automation industry. Optimum specific power, Low inertia, Excellent quality/price ratio.



► Caratteristiche standard - Standard features

- Linea completa da 0,045 a 2,7Nm - Complete line from 0,047 to 2,7Nm
- Magneti in ferrite - Ferrite permanent magnets
- Flange di montaggio personalizzabili - Special flanges and shafts
- Encoder abbinabili - Encoder available
- Connettori d'uscita fissi/estraibili - Flying screw connectors
- Momento d'inerzia ridotti - Low rotor inertia
- Riduttori epicicloidali e freni di stazionamento disponibili - Precision planetary gearboxes and/or brakes available.



Dati tecnici / Technical specifications

Type		PX 17			PX 30				PX 56 / 63							
		S1	S2	S3	S1	S2	S3	S4	S1	S2						
Stall torque	(Nm)	0.045	0.06	0.07	0.13	0.17	0.3	0.3	0.45	0.49	0.49	0.55	0.65	0.7	0.75	0.75
Nominal speed	(rpm)	3700	3300	1500	2750	2700	3000	3000	2600	2500	2600	2400	2400	2750	2600	1800
Stall current (24V)	IO (A)	1.4	1.7	0.95	2.5	3.1	5.2	-	6.3	-	7.3	-	10	-	-	-
Stall current (48V)	IO (A)	-	-	-	-	-	-	2.5	-	4.1	-	4	-	5.4	-	-
Stall current (65V)	IO (A)	-	-	-	-	-	-	-	-	-	-	-	-	-	4	2.9
Voltage constant	(V/ Krpm)	3.95	5.05	10	6.65	6.95	6.65	13.5	7.7	13.5	7.85	16.5	7.7	14.5	20.5	28.5
Tacho (opt)	2 poles	DT3 3V/KRPM			DT10 10/KRPM											
Brake (opt)	(Nm)	1Nm 24V 0.29A														
Rotor Inertia	Kgm ² *10 ⁻⁴	0.03	0.052	0.2	0.28	0.43	0.75	2.8	3.8							
Brake Inertia	Kgm ² *10 ⁻⁴	0.1														

Type		PX 63			PX 65 / 75						PX 75		
		S3			S1		S2				S3		
Stall torque	(Nm)	0.65	0.8	0.9	0.85	1	1.15	1.7	1.45	1.85	1.8	2.2	2.7
Nominal speed	(rpm)	2800	2700	2000	3700	2600	1900	1900	2900	3700	2700	2750	1800
Stall current (24V)	IO (A)	10	-	-	-	-	-	-	-	-	-	-	-
Stall current (48V)	IO (A)	-	5.9	5.6	-	-	-	-	-	-	-	-	-
Stall current (65V)	IO (A)	-	-	-	6.5	5.8	4.6	6.8	8.5	13	-	-	-
Stall current (90V)	IO (A)	-	-	-	-	-	-	-	-	-	7.4	8.7	7
Voltage constant	(V/ Krpm)	7.7	15	20	15	19.5	30	29.5	20	15	30	28.5	45
Tacho (opt)	2 Poles	DT10 10V/KRPM											
Brake (opt)	(Nm)	1Nm 24V 0.29A			2Nm 24V 0.39A								
Rotor Inertia	Kgm ² *10 ⁻⁴	5			3.9			7				8.5	
Brake Inertia	Kgm ² *10 ⁻⁴	0.1			0.24								

Specifiche tecniche standard:

Isolamento: Motore e avvolgimento in classe F secondo DIN 0530 - Insulation: Motor and winding in class F in accordance with DIN 0530
 Cuscinetti: Cuscinetti di alta qualità lubrificati a vita, bloccato anteriormente - Bearing: High quality, life lubricated, front bearing locked
 Grado di protezione: IP44 - Level of protection: IP44

► PX 17 Dimensioni e tolleranze - Dimension and tolerance

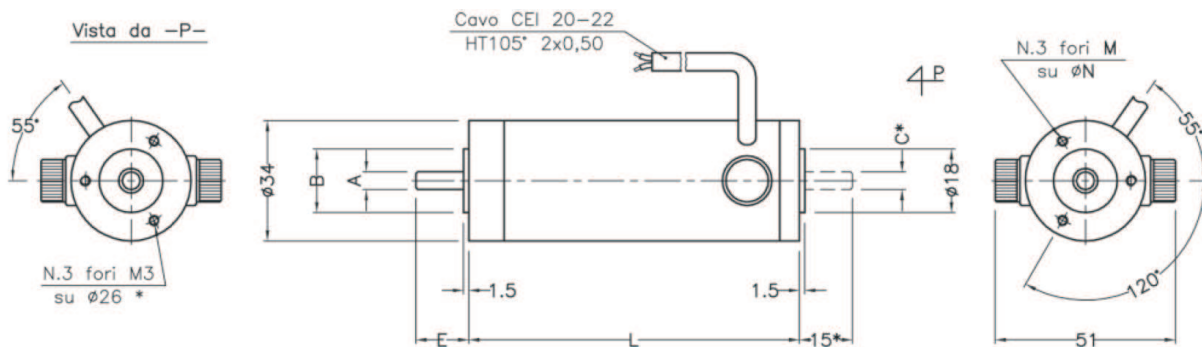

Taglia Size	A ^{h6}	B ^{h7}	C ^{h6}	E	L	L1	M	N	Key
PX 17 S1	5	18	6	15	74	121.5	M3	26	-
PX 17 S2	5	18	6	15	95	140.5	M3	26	-

Quote motore con freno - Dimensions motor with brake (L+33mm) L1= Quote motore con dinamo tachimetrica - L1=Dimensions motor with tacho
 Le quote non indicate stanno a significare che la versione non è disponibile - Where the dimensions are not given the version is not available

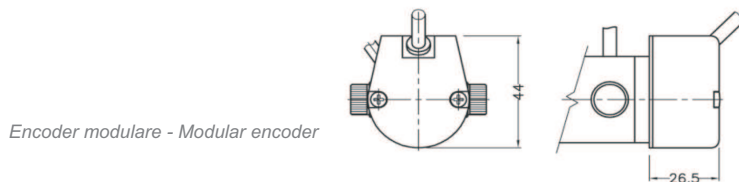

[Datasheet PX - 2 of 4]

► PX 30 Dimensioni e tolleranze - Dimension and tolerance

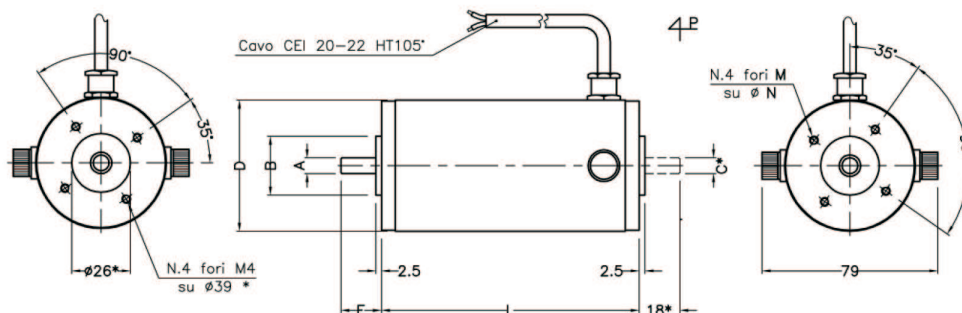

Taglia Size	Flangia Flange	A ^{h6}	B ^{h7}	C ^{h6}	D	E	L	L1	M	N	Key
PX 30 S1	Standard	6	26	6	58	18	72	-	M4	39	-
PX 30 S2	Standard	7	26	7	58	18	91	139	M4	39	-
	56B14	9	50	7	75	20	93	146	M5	65	3X3X15
PX 30 S3	Standard	7	26	7	58	18	117	165	M4	39	-
	56B14	9	50	7	75	20	119	172	M5	65	3X3X15
	63B14	11	60	7	60	23	120	-	5.5	75	4X4X15
PX 30 S4	Standard	9	26	7	58	18	168,5	222	M5	39	3X3X15
	56B14	9	50	7	75	20	170	223,5	M5	65	3X3X15
	63B14	11	60	7	60	23	170	-	5.5	75	4X4X15

Quote motore con freno - Dimensions motor with brake (L+33mm) L1= Quote motore con dinamo tachimetrica - L1=Dimensions motor with tacho
 Le quote non indicate stanno a significare che la versione non è disponibile - Where the dimensions are not given the version is not available

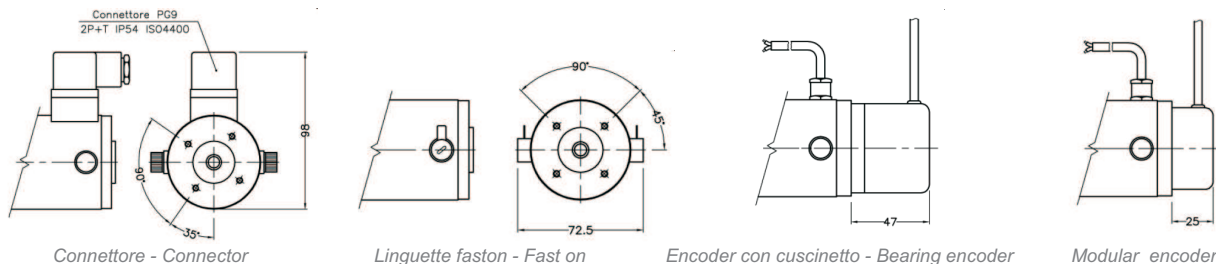

Technical alteration reserved. Specification subject to change without notice. All rights reserved

► PX 56 / 63 Dimensioni e tolleranze - Dimension and tolerance

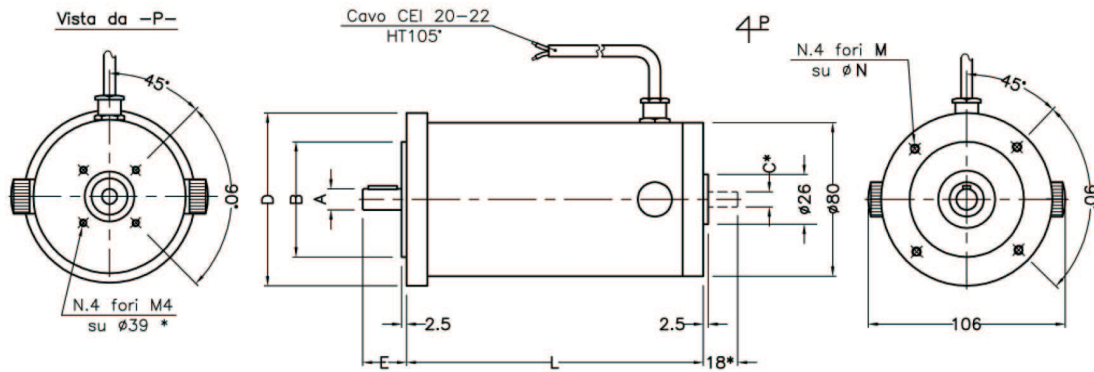

Taglia Size	Flangia Flange	A ^{h6}	B ^{h7}	C ^{h6}	D	E	L	L1	M	N	Key
PX56/63 S1	56B14	9	50	8	80	20	140	192	M5	65	3X3X15
	63B14	11	60	8	90	23			M5	75	4X4X15
	63B5	11	95	8	140	23			8,5	115	4X4X15
PX56/63 S2	56B14	9	50	8	80	20	157,5	210	M5	65	3X3X15
	63B14	11	60	8	90	23			M5	75	4X4X15
	63B5	11	95	8	140	23			8,5	115	4X4X15
PX56/63 S3	56B14	9	50	8	80	20	185,5	238	M5	65	3X3X15
	63B14	11	60	8	90	23			M5	75	4X4X15
	63B5	11	95	8	140	23			8,5	115	4X4X15

Quote motore con freno - Dimensions motor with brake (L+46mm) L1= Quote motore con dinamo tachimetrica - L1=Dimensions motor with tachometer

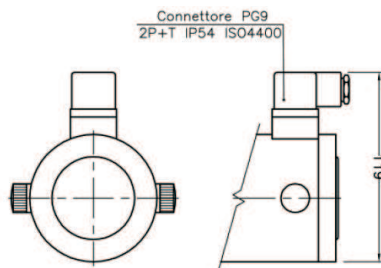

Connettore - Connector

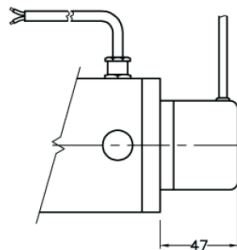

Encoder con cuscinetto - Bearing encoder

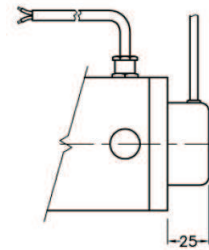

Modular encoder

► PX 65 / 75 Dimensioni e tolleranze - Dimension and tolerance

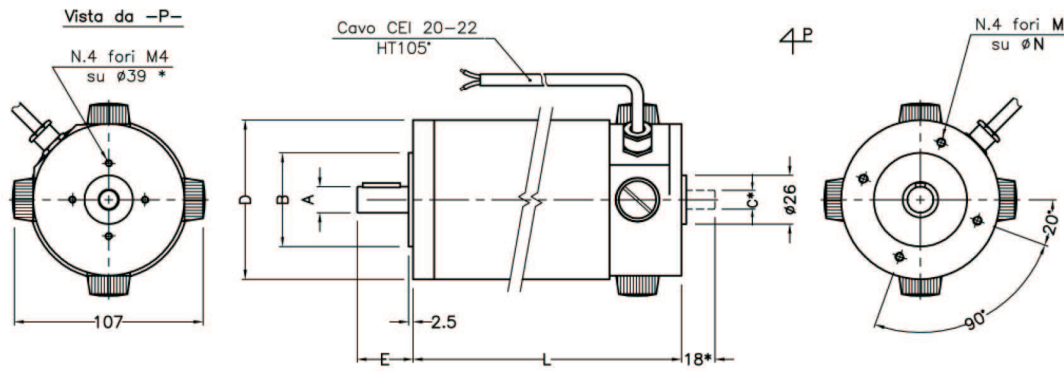

Taglia Size	Flangia Flange	A ^{h6}	B ^{h7}	C ^{h6}	D	E	L	L1	M	N	Key
PX65/75 S1	56B14	11	50	10	84	23	146	208	M5	65	4X4X15
		14				5X5X20					
	63B14	11	60	10	90	23			M5	75	4X4X15
	71B14	14	70	10	105	30					
	63B5	11	95	10	140	23					
PX65/75 S2	56B14	11	50	10	84	23	206	268	M5	65	4X4X15
		14				5X5X20					
	63B14	11	60	10	90	23			M5	75	4X4X15
	71B14	14	70	10	105	30					
	63B5	11	95	10	140	23					
PX65/75 S3	56B14	11	50	10	84	23	268	330	M5	65	4X4X15
		14				5X5X20					
	63B14	11	60	10	90	23			M5	75	4X4X15
	71B14	14	70	10	105	30					
	63B5	11	95	10	140	23					
	71B5	14	110	10	160	30	8,5	115	4X4X15		
									8,5	130	5X5X20

Quote motore con freno - Dimensions motor with brake (L+46mm) L1= Quote motore con dinamo tachimetrica - L1=Dimensions motor with tachometer

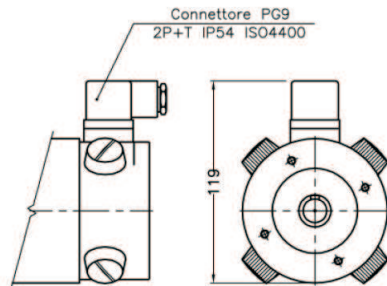

Connettore - Connector

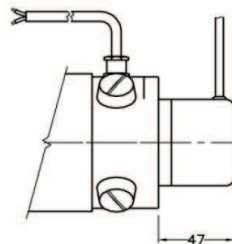

Encoder con cuscinetto - Bearing encoder

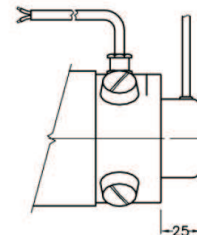

Modular encoder

Ordering code example:

PX - 30 - S2 - 24 - 2700 - X - XX - 1 - X - XX

Product name: _____
Model: _____

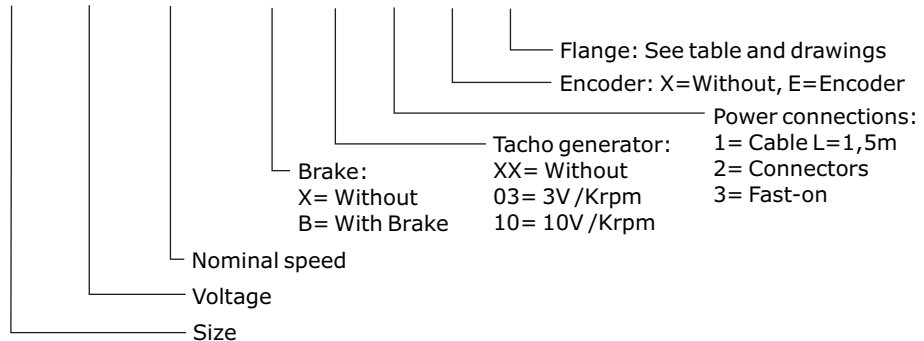

[Datasheet PX - 4 of 4]
Technical alteration reserved. Specification subject to change without notice. All rights reserved